

Cavicloak

preformed damp courses

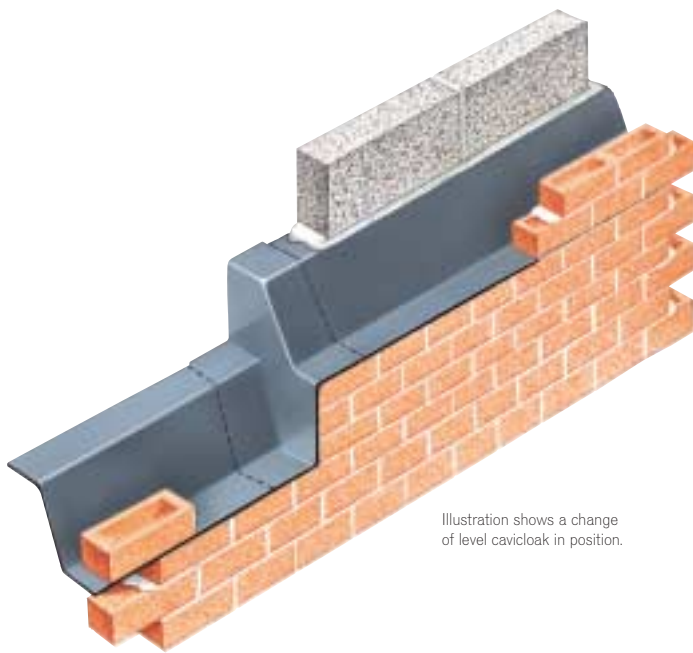

Illustration shows a change of level cavicloak in position.

- Ready-shaped modular DPC cloaks
- Modular components eliminate site fabrication variances
- Accurate scheduling and stock control
- Upstand termination option (self-supporting or return into inner skin)
- Ready to use - no wastage

problem

How to create preformed moulded cloaks for use within cavity walls. Cavicloaks are shaped to exactly fit the construction detail intended. Cavicloaks are offered in a wide range of popular sizes. Also tailor-made to suit specific applications.

introduction

The use of preformed cavicloaks eliminates the need to fabricate on site. The ready-moulded units provide correctly fitting harmonizing components which ensure DPC integrity to features such as corners, columns, steps and angles.

solution

Cavicloaks are moulded from solid polypropylene A1 DPC. The material is supple yet self-supporting. Preformed units offer flexibility, without sagging or distorting. Additional support is not required to the joints. Cavicloaks are overlapped 150mm and then further united using 100mm wide link-seal strips which promote positive jointing with the adjoining appropriate DPC or cavity tray system. Cavicloaks are available to suit a wide

range of cavity widths. Options include the self-supporting cavity upstand terminating within the cavity or alternatively the self-supporting upstand returning into the inside skin, depending on application. Preformed cavicloaks provide the reliable alternative to cutting and fabricating on site. Cavicloaks ensure perfect stock control, eliminate all waste and permit the architect and contractor to schedule accurately, thus eliminating the possibility of installer/fabricator error.

cavicloak lengths

The preformed profile of each cavicloak is available in long lengths, if it is desired not to use traditional roll DPC between units. Specify clearly if this option is required.

pipe cavicloaks

Service pipe entry point cavicloaks are available in a range of sizes. Service pipe entry cloaks are manufactured in one piece, with an accompanying integrity sealing strip which is applied around the cloak to seal the cloak outlet.

sizes

Standard cavicloaks are available to suit most popular construction details. Purpose-made cavicloaks are available to suit special applications. The following information is required: Cavity width. Upstand vertical rise within cavity, ie 150mm, 225mm or other. Upstand termination option. Any other relevant information. Cavity Trays Limited will be pleased to schedule and calculate requirements for any size of project. There is no charge for this service for which we are responsible for component selection. Component schedules for client approval are issued.

material

Solid Polypropylene preformed A1 DPC. Securtext

surface finish. Origination thickness 1.5mm.

colour

Black.

installation/site work

Before commencing building-in, we recommend all components are placed in position to ensure suitability and fit. Ensure relationship with any adjoining DPC or tray system is correct. Components may then be removed and installation may proceed, observing good building practice/ BS5628/BS8215. Always bed on mortar, do not dry bed.

Ensure surfaces of cavicloaks and any adjoining tray or DPC system are completely clean and dry and overlap the cavicloak 150mm minimum. Apply self-adhesive link-seal

designers' comments

The ability of cavicloaks to self-support offers advantages as product application may be independent of the internal skin if so desired. The upstand termination option permits versatile use with cast concrete, structural steel and timber-frame inside skin/cavity projections. Cavicloaks promote construction control and consistent quality.

technical observations

Preformed moulded components. Link-seal jointing. Upstand termination option. No distortion or sagging. Efficient site scheduling and stock control. Branded with name and logo as proof of type and accompanying warranty.

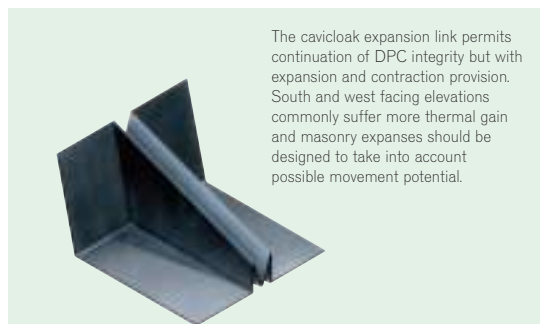

The cavicloak expansion link permits continuation of DPC integrity but with expansion and contraction provision. South and west facing elevations commonly suffer more thermal gain and masonry expanses should be designed to take into account possible movement potential.



Cavicloak

preformed damp courses

- Ready-shaped modular DPC cloaks
- Modular components eliminate site fabrication variances
- Accurate scheduling and stock control
- Upstand termination option*
- Ready to use - no wastage

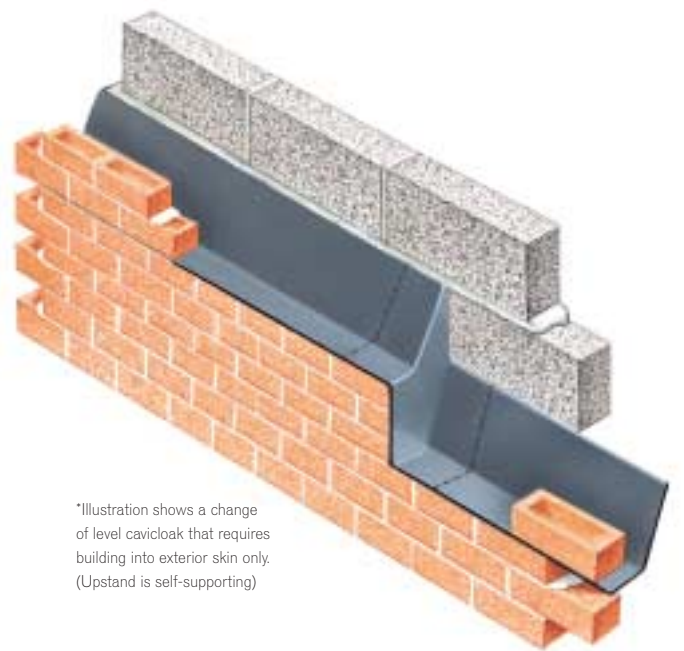

*Illustration shows a change of level cavicloak that requires building into exterior skin only. (Upstand is self-supporting)

strip over entire overlap, so that strip is equally positioned on the cloak and on adjoining medium.

Fixing instructions accompany all consignments. If in doubt do not proceed but seek advice immediately

bill of quantity wording

Self-supporting cavicloaks

Sizes as schedule prepared by Cavity Trays Limited. Bed preformed cavicloaks within horizontal mortar joints at the appropriate course level as work proceeds.

Follow carefully the installation instructions which accompany every consignment. Ensure all installation is strictly in accordance with the manufacturer's instructions.

Request liability/conformity document upon completion.

ordering/regulations

See inside back cover for details.

related products and applications

Drainage of water from cavicloaks is recommended via perp weeps of which there are three options.

See Type W Weepvent, Euroweep-vent, beak weep

and small weepvent. Cavicloaks may be linked to our sitesealer membranes when incorporated to protect the oversite, see Type N.

If cavicloaks are to be used to act as steps and corners linked to traditional rolled DPC, consider Caviroll Premium DPC. Alternatively, long preformed straights may be utilised which are available to match the cavicloak profiles.

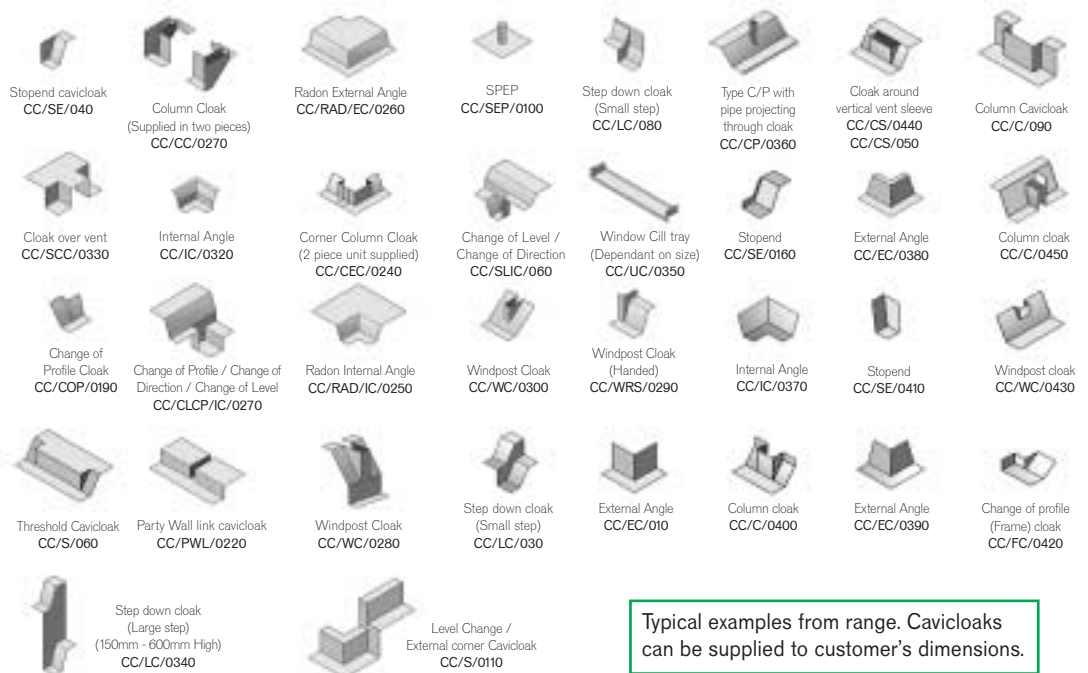

Typical examples from range. Cavicloaks can be supplied to customer's dimensions.

